

# Everdry Stepped Cavity Trays for Stonework

Stepped cavity tray system for multi cavity options in stone wall construction of 150mm course heights

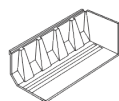

Intermediate tray (LH)

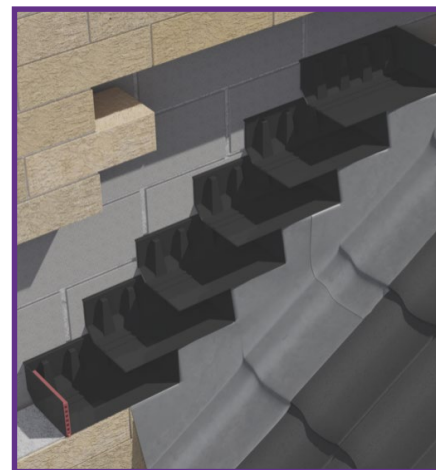

Stopend starter tray (LH/RH)

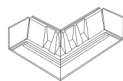

Corner starter tray (RH)



Ridge tray

## Use

- At the abutment of a pitched roof with a cavity wall
- On external walls - not exceeding 150mm thickness - built from natural or reconstituted stone with regular course heights, including mortar of approx. 150mm
- On roof pitches of 7.5 degrees and above
- Clear cavity widths of between 50mm-125mm

## Features and Benefits

- 150mm high back upstand exceeds minimum requirements
- Permanent stopend protects the perpendicular joint and cuts out water backtracking along the stonework
- Angled section between cavity tray base and rear upstand automatically sheds water to the outer leaf
- Cavity tray builds into the outer leaf only to speed up installation and allow both inner and outer leaves to be built independently if required
- Choice of three lengths: 450mm for roof pitches of 25 degrees or above; 625mm for roof pitches of 17.5-22.5 degrees; 1250mm for roof pitches of 7.5-15 degrees
- The system is available on request with pre-applied polystyrene strips. Polystyrene is much easier to rake out than mortar and offers a visual locator of the cavity tray so aiding the installation of post fitted lead work. (This service may incur additional charge)

## Quality

- BBA Approved
- Satisfies all NHBC requirements
- Manufactured to BS EN ISO 9001 and BS EN ISO 14001
- Complies with all relevant Building Regulations
- Meets all relevant British Standards

## Material and Colour Choice

- All products are vacuum formed in 2.0mm thick medium density polyethylene
- Available in black only

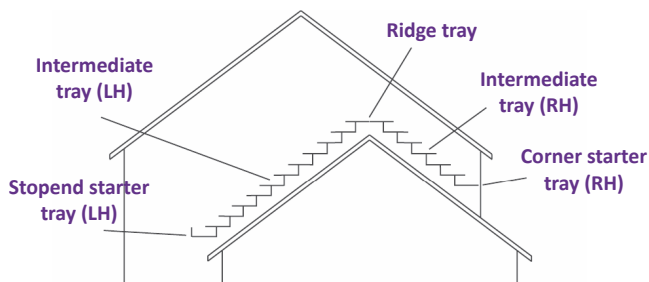

## Products in the Range

### Intermediate trays

Forms main tray run with one tray on each course of stonework running the full length of the abutting roof slope.

### Stopend starter trays

Suits all roof pitches - first component to be installed and fitted at the lowest point on a standard abutment. It collects water gathered by the rest of the system and discharges it from the wall through a weep hole.

### Corner starter trays

Suits all roof pitches - has same function as stopend starter tray but is used where the abutting roof comes up to, or beyond, the corner of the main building. Designed to return around the corner of the building to provide complete protection.

### Ridge trays

Suits all roof pitches - used where a right hand and left hand roof slope come together at an apex to straddle the top two intermediate trays.

## Installation Advice

- Each length of tray is available with a variety of base widths to suit different wall thicknesses and cavity width combinations. Wall thicknesses of either 100mm, 125mm or 150mm can be accommodated as well as cavity widths of 50-74mm, 75-99mm and 100-125mm - make sure you select the correct width for the project in hand
- Weep holes can be formed by simply installing a purpose-made Timloc plastic wall weep unit (product 1143/Invisiweep)
- In areas of severe weather exposure or where particularly porous facing stonework is used, it is strongly recommended that extra weep holes are provided at intermediate points along the run of cavity trays
- Many components come in left or right handed versions. Handing is dictated by the direction of the abutting roof slope - e.g. left handed trays are used on left handed roof slopes. Establish the correct handings or it will be impossible to fit the cavity trays properly
- With pre-formed cavity trays such as Everdry it is not strictly necessary for the cavity tray to span all the way across the cavity. As long as the cavity tray stands back from the rear face of the stone and projects back into the cavity far enough to intercept drips falling from the wall ties, then it will perform effectively.

# Everdry Stepped Cavity Trays for Stonework

Free cavity tray specification and scheduling service

Contact Technical on 01405 765 567

Stepped cavity tray system for multi cavity options in stone wall construction of 150mm course heights

## How to Order

- To calculate quantities allow one cavity tray per course on each roof slope. One stopend starter or corner starter is needed per roof slope, and one ridge tray at each apex
- Check roof pitch and select correct length of tray to suit it
- Make sure correct handing is selected to suit the direction of each roof slope
- Always state cavity width, roof pitch, coursing height and wall thickness to ensure correct goods are despatched

## Bill of Quantity

F30 Accessories/sundry items for brick/block/stone walling  
Clause

370 | PREFORMED CAVITY TRAY / ACCESSORIES

- Manufacturer: **Timloc Building Products, Timloc House, Ozone Park, Howden, East Yorkshire, DN14 7SD. T: 01405 765567 W: www.timloc.co.uk**
- Type(s) and location(s): Cavity tray to be installed into 150mm stonework over stepped/sloping roof abutments on new build and remedial work applications.
- Build in carefully in accordance with manufacturer's recommendations to ensure a fully watertight installation.
- Cavity width: ...
- External wall thickness: ...
- Roof pitch: ...
- Reference: e.g. Intermediate Tray (RH) 450mm long (roof pitches 25°+)

## Product Codes

150mm stone coursing  
100mm external wall thickness (bed)

Description	Length	Product codes to suit clear cavity widths of:		
		50-74mm	75-99mm	100-125mm
Intermediate tray RH	450mm	7101	7103	7105
Intermediate tray LH	450mm	7102	7104	7106
Intermediate tray RH	625mm	7111	7113	7115
Intermediate tray LH	625mm	7112	7114	7116
Intermediate tray RH	1250mm	7121	7123	7125
Intermediate tray LH	1250mm	7122	7124	7126
Stopend starter tray RH/LH	450mm	7131	7133	7135
Corner starter tray RH	550mm	7141	7143	7145
Corner starter tray LH	550mm	7142	7144	7146
Ridge tray	450mm	7161	7162	7163

150mm stone coursing  
125mm external wall thickness (bed)

Description	Length	Product codes to suit clear cavity widths of:		
		50-74mm	75-99mm	100-125mm
Intermediate tray RH	450mm	7103	7105	7107
Intermediate tray LH	450mm	7104	7106	7108
Intermediate tray RH	625mm	7113	7115	7117
Intermediate tray LH	625mm	7114	7116	7118
Intermediate tray RH	1250mm	7123	7125	7127
Intermediate tray LH	1250mm	7124	7126	7128
Stopend starter tray RH/LH	450mm	7133	7135	7137
Corner starter tray RH	550mm	7143	7145	7147
Corner starter tray LH	550mm	7144	7146	7148
Ridge tray	450mm	7162	7163	7164

150mm stone coursing  
150mm external wall thickness (bed)

Description	Length	Product codes to suit clear cavity widths of:		
		50-74mm	75-99mm	100-125mm
Intermediate tray RH	450mm	7105	7107	7109
Intermediate tray LH	450mm	7106	7108	7110
Intermediate tray RH	625mm	7115	7117	7119
Intermediate tray LH	625mm	7116	7118	7120
Intermediate tray RH	1250mm	7125	7127	7129
Intermediate tray LH	1250mm	7126	7128	7130
Stopend starter tray RH/LH	450mm	7135	7137	7139
Corner starter tray RH	550mm	7145	7147	7149
Corner starter tray LH	550mm	7146	7148	7150
Ridge tray	450mm	7163	7164	7165

Trays to suit clear cavity widths of 126mm+ and 151mm external wall thickness can be made to order.

For trays featuring the polystyrene strip mortar barrier insert 'P' at the end of the required product code. This may incur additional charge.