

Over Lintel, General Purpose and Parapet Horizontal Cavity Trays

A range to protect modern steel lintels, general purpose horizontal and parapet cavity applications

Free cavity tray specification and scheduling service
Contact Technical on 01405 765 567

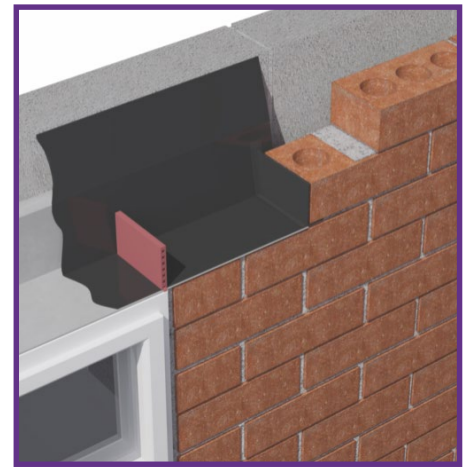

Use

- Over steel lintels in external cavity walls (LCT)
- General purpose horizontal cavity applications such as floor beams, abutments and meter boxes (GCT)
- For parapet walls (HPT)

Features and Benefits

- Fully self supporting cavity tray system built independently from inner leaf
- Available for all coursing heights and styles with options available to suit all cavity variations
- Full range of cut to length sizes available
- No site fabrication, no waste, easy to handle and install
- Consistency and build quality maintained, cost effective

Quality

- Tough, durable, scratch resistant and puncture resistant
- Manufactured to BS ISO 9001 and BS EN 14001
- Meets all relevant British Standards
- Meets all documented cavity tray requirements
- Meets all NHBC recommendations

Material and Colour Choice

- Manufactured from black 2mm polypropylene
- A high quality product that is rigid yet durable for site conditions

Installation Advice - Lintel Trays

- Lintel cavity trays must be combined with lintel stopends and proprietary weep hole units to achieve their full potential of being a system which offers maximum water catchment and discharge properties for above openings
- Standard length 2.5mtrs in one piece

Contact Timloc Technical department for installation guidance.

How to order

- Two stopends and weep holes at 450mm centres (minimum of two weep holes) are required per lintel/tray
- Consult lintel manufacturer to confirm lintel upstand height and select next available LCT height (either 100mm, 150mm or 225mm)
- Calculate the length of LCT required by adding a minimum of 300mm to length of lintel. This will give adequate cavity tray length to allow stopends to be inserted into the next perp joint away from the opening
- Add the appropriate LCT length to the product code before ordering
- The standard range of lintel cavity tray has been designed to suit the most popular types of steel lintel

Bill of Quantity

F30 Accessories/sundry items for brick/block/stone walling

Clause

485^ PREFORMED CAVITY TRAY / ACCESSORIES

- Manufacturer: **Timloc Building Products, Timloc House, Ozone Park, Howden, East Yorkshire, DN14 7SD. T: 01405 765567 W: www.timloc.co.uk**
- To extend not less than 150mm beyond ends of lintels/bridgings.
- Reference: **LCT lintel cavity trays**
- Lintel Rise: **(100mm, 150mm or 225mm)**
- Cavity width: **(50mm, 75mm or 100mm)**

Product Codes

LCT lintel, GCT and HPT horizontal cavity trays

Description	Colour	Product codes to suit clear cavity widths of		
		50mm	75mm	100mm
LCT100 Lintel tray	Black	5001	5002	5003
LCT150 Lintel tray	Black	5004	5005	5006
LCT225 Lintel tray	Black	5007	5008	5009
GCT50 Horizontal tray	Black	5201	-	-
GCT75 Horizontal tray	Black	-	5202	-
GCT100 Horizontal tray	Black	-	-	5203
HPT50 Horizontal tray	Black	5301	-	-
HPT75 Horizontal tray	Black	-	5302	-
HPT100 Horizontal tray	Black	-	-	5303

Trays to suit clear cavity widths of 101mm+ can be made to order.

Corners, stopends and joining tape are available to offer a fully sealed/water tight system. Other variants of GCT available to order.

