

Goliath Channel System

Technical Datasheet

Datasheet Issue Date: 30th January 2026



25/15 Channel System

Goliath 25/15 channel is a UKCA fully tested system that offers a 60-year warranty. Designed to tie the masonry outer leaf of a cavity wall into the internal leaf, this can be constructed of either light gauge steel or concrete, with an insulation thickness up to 230mm.

Product Overview

Goliath Channel 25/15 is made from grade 304 stainless steel and comes in 2.7m lengths with pre-formed holes; the smaller hole is to ensure that only the SFS fixing can pass through, with the larger hole for the concrete fixing. The system consists of channel, ties, fixings and compression sleeves.



Performance in accordance with PD6697 assuming studs at 600mm centres

Tie Type – PD6697:2019	Vertical Fixing Spacing (mm)	Vertical Tie Spacing (mm)
Type 1*	450	300
Type 2	450	375

*Type 1 can be achieved with just 6 fixings and 9 ties

Wall Tie Range

Goliath stainless-steel wall tie range has been designed with ease of installation. To install the ties first locate the notches into the lips of the channel and simply twist the channel tie into the channel ensuring the drip is pointing down. The ties can then easily slide up and down, enabling them to be fitted anywhere along the channel to align with the bed joint coursing at the required vertical centres.

GT/CT - Reference	Tie Length (mm)	Cavity Range (mm)
GT/CT/100	100	35 - 59
GT/CT/125	125	60 - 84
GT/CT/150	150	85 - 109
GT/CT/175	175	110 - 134
GT/CT/200	200	135 - 159
GT/CT/225	225	160 - 184
GT/CT/250	250	185 - 209
GT/CT/275	275	210 - 234
GT/CT/300	300	235 - 259

Compression Sleeves

Compression sleeves are required and should be the same length as the insulation thickness. This ensures the system maintains its required compressive strength and stability during installation and throughout its lifespan and does not compress the insulation.

Head Office: Magna 34 Industrial Park, Temple Road, Rotherham, England S60 1FG
03448 50 40 50 | technical@grayson-gb.com

UK
CA



Goliath Channel System

Technical Datasheet

Datasheet Issue Date: 30th January 2026



Steel Framing System Install

Offer up the Goliath channel to the insulation ensuring it is central to the SFS upright behind, mark and puncture the insulation through the smaller hole with the fixing and then insert the compression sleeve into the insulation. Fix the screw through the compression sleeve into the SFS using a Tek gun. Ensure the channel is vertical using a spirit or laser level, then puncture the remaining holes through the insulation. Rotate the channel to the side and install the compression sleeves, realign the channel back and install the fixings through the channel. SFS studs are generally set at 600 mm horizontal centres.

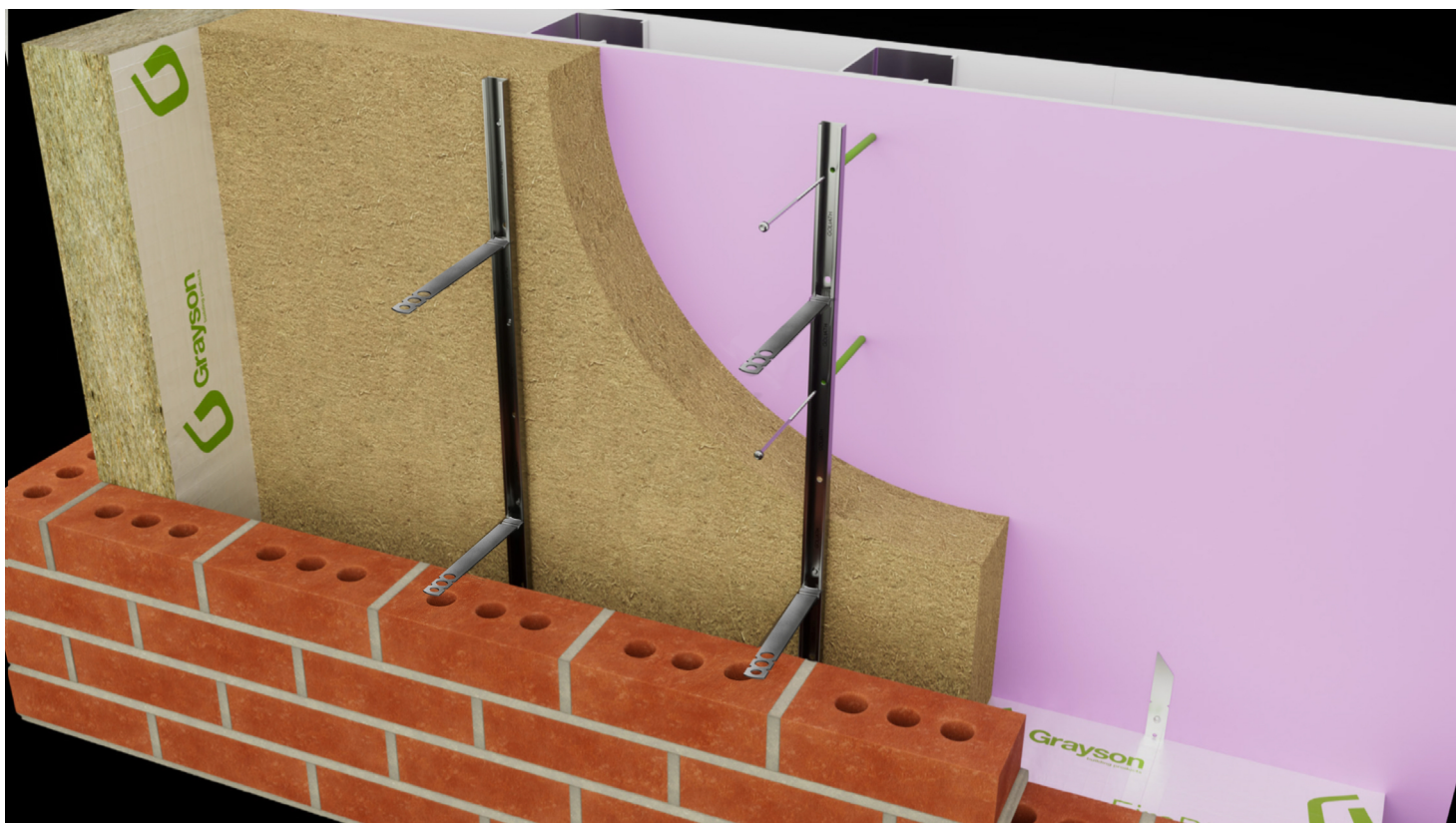

SFS Fixings

Grayson Fixing Reference	Length (mm)	Fixing Range (mm)
TSHTS12SS55X065	65	25 – 47
TSHTS12SS55X085	85	40 – 67
TSHTS12SS55X105	105	50 – 87
TSHTS12SS55X130	130	75 – 112
TSHTS12SS55X150	150	95 – 132
TSHTS12SS55X180	180	105 – 162
TSHTS12SS55X210	210	135 – 192
TSHTS12SS55X230	230	155 – 212
TSHTS12SS55X270	270	195 - 252

Head Office: Magna 34 Industrial Park, Temple Road, Rotherham, England S60 1FG
03448 50 40 50 | technical@grayson-gb.com

UK
CA



Goliath Channel System

Technical Datasheet

Datasheet Issue Date: 30th January 2026



Concrete Substrate Install

Offer up the Goliath channel to the insulation, mark and puncture the insulation through the larger hole with the fixing and then insert the compression sleeve into the insulation. Drill the required size hole through the compression sleeve and then fix the channel with a concrete screw through the compression sleeve. Ensure the channel is vertical using a spirit or laser level, then puncture the remaining holes through the insulation. Rotate the channel to the side and install the compression sleeves, drill the holes through the sleeves, realign the channel back and install the fixings through the channel.

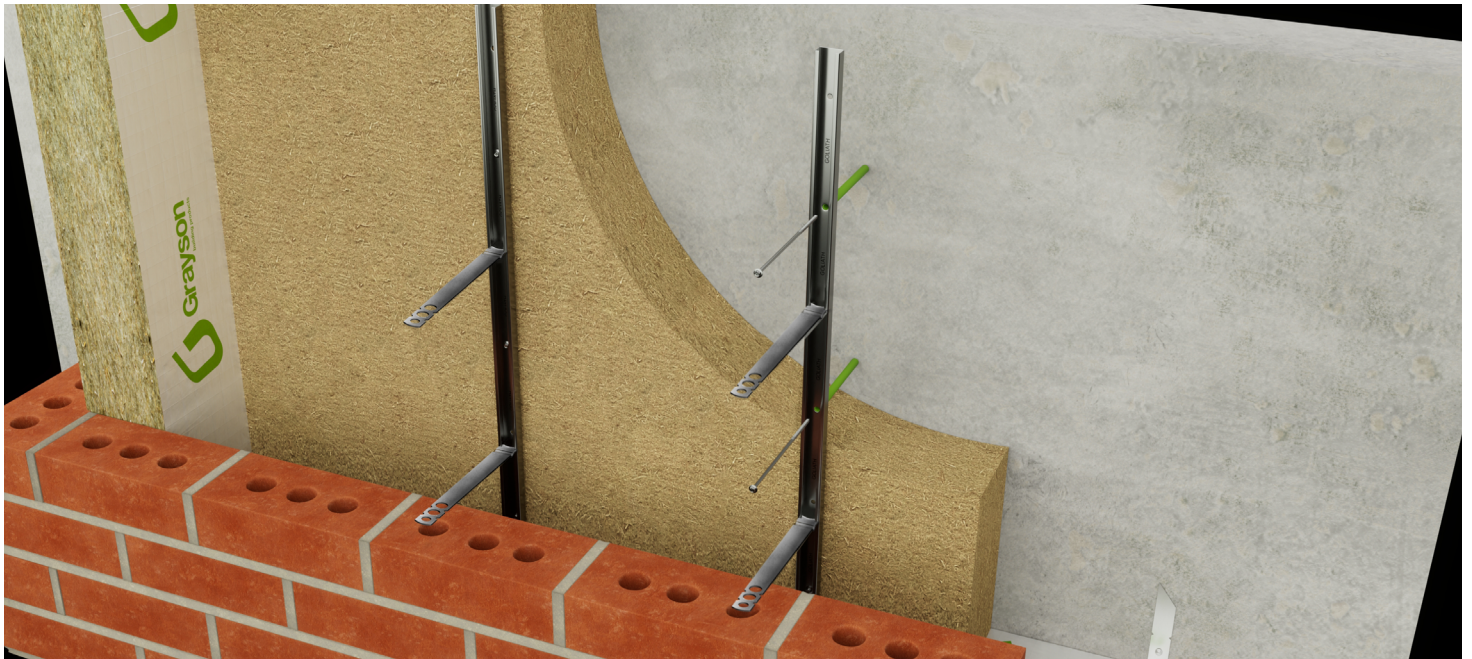

Concrete Fixings

Grayson Fixing Reference	Length (mm)	Fixing Range (mm)
CSHA263X055	55	1 - 15
CSHA263X100	100	50 - 65
CSHA263X125	125	60 - 90
CSHA263X150	150	85 - 115
CSHA263X175	175	110 - 140
CSHA263X200	200	135 - 165
CSHA263X230	230	165 - 195
CSHA263X250	250	185 - 215
CSHA263X275	275	210 - 240

Standard embedment is 35mm based on a C25 concrete

UKCA Testing Body	Lucideon Ltd, Queens Road, Penkull, Stoke on Trent. ST4 7QL
Notification Body No	1289
Declaration of Performance	For our GT/CT tie range contact technical@grayson-gb.com

Head Office: Magna 34 Industrial Park, Temple Road, Rotherham, England S60 1FG
03448 50 40 50 | technical@grayson-gb.com

